

ICELAND SKATE STORAGE SHED

PROPOSED
ELECTRICAL

9/28/13

BREAKER NO. 19 WALL RECEPTICAL, GFI, NR. REFRIGERATOR SECOND CIRCUIT

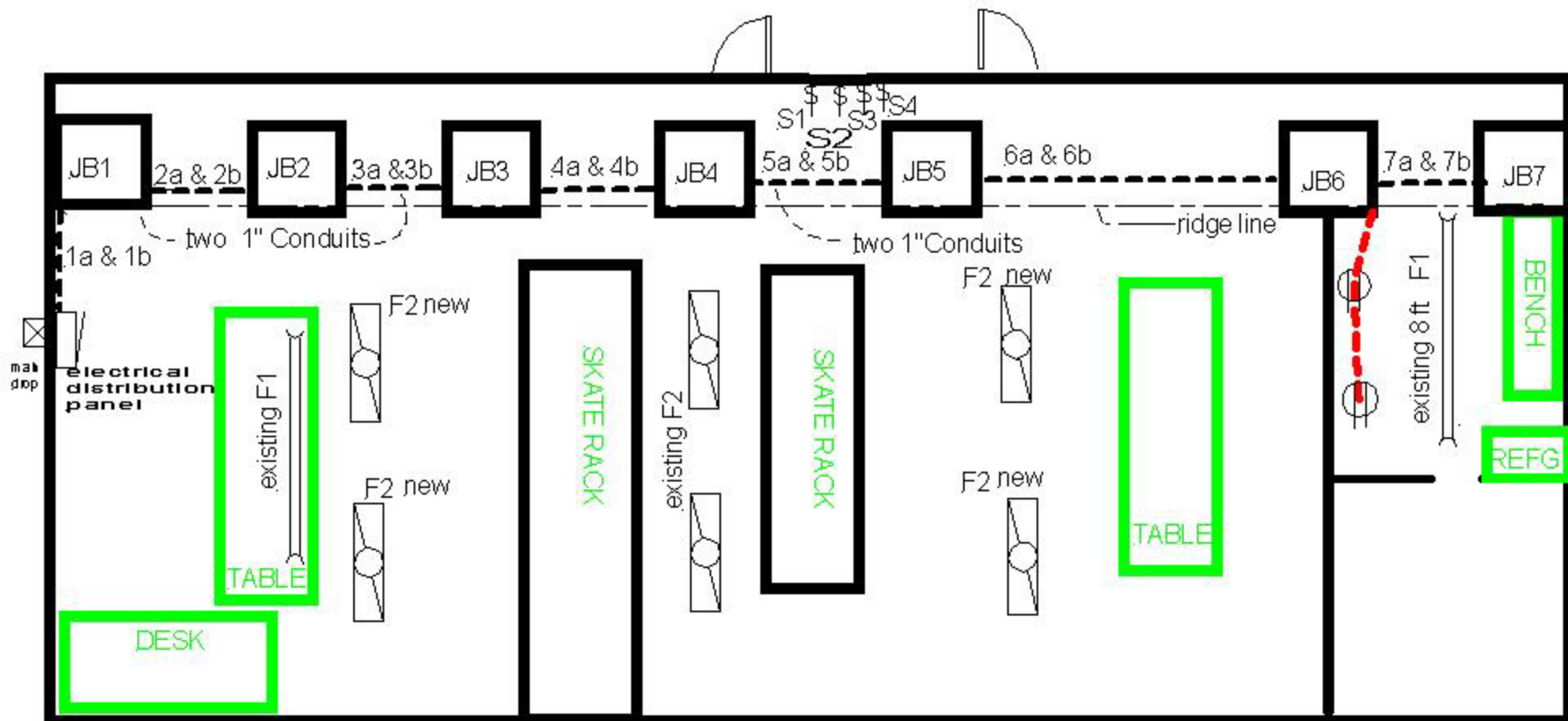

NOTES:

RED IS 1/2 EMT or 1/2 ARMOR FLEX

F1 is a two bulb T8 8ft flourescent lamp

F2 is a two bulb T8 4ft flourescent lamp

JB 6X6 junction box

feeds from JB to F2 lights are 3/8 armored flex

two 1" EMT from JB to JB at ridge line, feeds to recepticals is EMT or 1/2" armor flex.

.1a, 1b



S1 breaker 1

S2 breaker 2

S3 breaker 11

S4 breaker 12

Conduit ID

Telephone jack

4 ft flourescent light

8 ft flourescent light

under eve recepticals

under eve recepticals

